

Cesoie CC
CC Circular shearing machine

Spessore taglio
Cut thickness

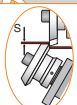

(S) mm	Al (22)	Fe (45)	Inox (70)
CC 400	2	1	0,5
CC 1000	5	3	2
CC 1000puls	6	4	2,5
CC 1300	5	3	2
CC 1300plus	6	4	2,5
CC 1800	7	5	4
CC 2200	7	5	4

Bordatura
Edging

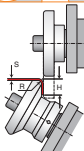

mm	S (max)	H (max)	R (max)
CC 400	-	-	-
CC 1000	1,5	18	3
CC 1300	1,5	18	3
CC 1800	2,5	30	3
CC 2200	2,5	30	3

Esempi di bordature
examples of beadingstr

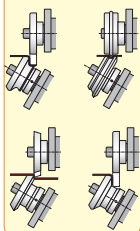

Modello / Model	CC400	CC1000	CC1000Plus	CC1300	CC1300Plus	CC1800	CC2200
Articolo / Item (P)	A311100	A313100	A316100	A324100	A325100	A330100	-
Articolo / Item (I)	-	A315100	-	-	-	-	-
Diametro taglio disco (max)] Cut diameter disk (max)]	400 mm	1000 mm	1000 mm	1300 mm	1300 mm	1800 mm	2200 mm
Diametro taglio disco (min) Cut diameter disk (min)	50 mm	130 mm	130 mm	130 mm	160 mm	240 mm	240 mm
Velocità taglio Cut speed	0÷40 m/min	0÷60 m/min	0÷60 m/min	0÷60 m/min	0÷60 m/min	0÷60 m/min	0÷60 m/min
Diametro lame Blades diameter	ø 54 mm	ø 74 mm	ø 74 mm	ø 74 mm	ø 90 mm	ø 120 mm	ø 120 mm
Chiusura lame Blades closing	(P)	(P) - (I)	(I)	(P) - (I)	(I)	(I)	(I)
Chiusura archetto Bow closing	(P)	(P)	(I)	(P)	(I)	(I)	(I)
Potenza assorbita Absorbed power	0,75 kW	1,1 kW	1,5 kW	1,1 kW	1,5 kW	3 kW	3 kW
Potenza centralina idraulica Absorbed power	-	0,5 kW	0,75 kW	0,75 kW	0,75 kW	1,1 kW	1,1 kW
Tensione di alimentazione Voltage	400V, ~ 3, 50/60 Hz						
Peso / Weight	150 kg	480 kg	520 kg	540 kg	650 kg	1200 kg	1450 kg

] da lastra quadrata / from square plate - (P) azionamento pneumatico / pneumatic driving
(I) azionamento idraulico / hydraulic driving

Dimensioni
Dimensions

mm	L ₁	L ₂	P*	H
CC 400	875	1030	360	1370
CC 1000	1650	1900	1000	1650
CC 1300	1650	2250	1230	1650
CC 1800	2400	3110	1540	1770
CC 2200	2700	3500	1820	1770

* incluso piano reggidisco
* disk-holder plain included

mm	A	B
CC 400	100	295
CC 1000	240	720
CC 1300	320	1000
CC 1800	390	1285
CC 2200	460	1560

A: incavo testa / head gap
B: incavo archetto / bow gap

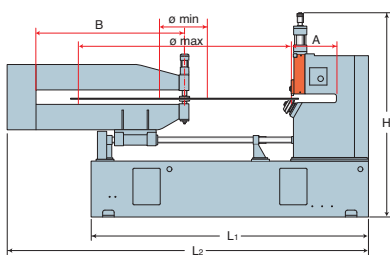

CC 1000

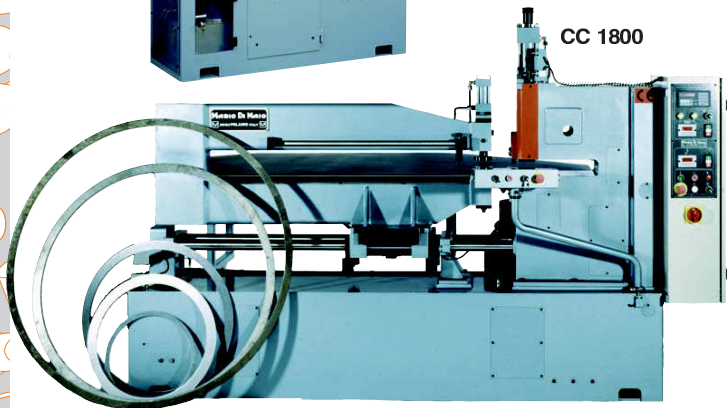

CC 1800

Cesoie ALDEBARAN
Circular shearing machine

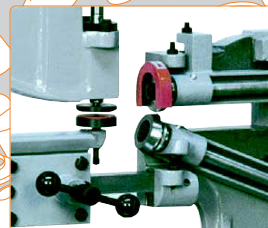

Spessore taglio
Cut thickness

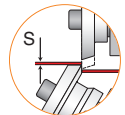

(S) mm	Fe (45 kg/mm ²)	Inox (70 kg/mm ²)
T400	1,0	0,5
T700	2,0	1,5
T1100	2,0	1,5
T1400	3,0	2,0
T2500S	1,5	1,0
T2000DF	3,0	2,0

mm

	A	B
T400	160	330
T700	250	500
T1100	250	500
T1400	440	1000
T2500S	250	1365
T2000DF	440	--

A: incavo testa / head gap
B: incavo archetto / bow gap

Dimensioni
Dimensions

mm	L ₁	L ₂	P	H
T400	875	1100	360	1210
T700	1320	1660	590	1530
T1100	1870	2420	590	1530
T1400	2400	3100	690	1600
T2500S	2350	3495	930	1440
T2000DF	2455	--	1330	1950

Cesoie circolari serie Aldebaran per tagli circolari (taglio dischi)
Aldebaran circular shearing machines (disks cutting)

Versione senza archetto
Version without bow

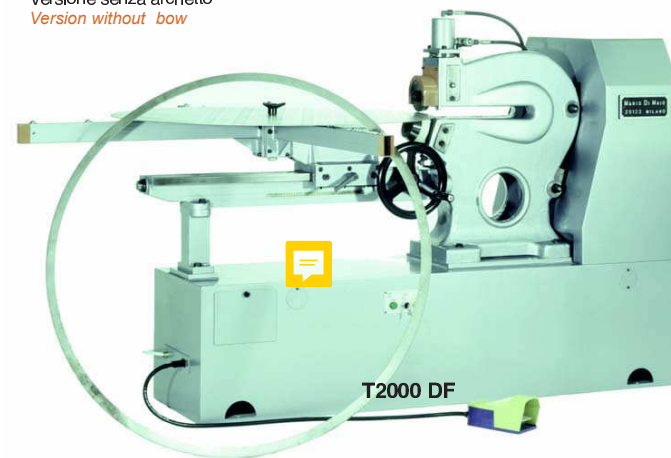

T2000 DF

Modello / Model	T400	T700	T1100	T1400	T2500S	T2000DF
Articolo / Item (P)	A302100	A304100	A306100	A307100	A340100	-
Articolo / Item (M)	A301100	A303100	A305100	-	--	o.r
Diametro taglio disco (min) Cut diameter disk (min)	70 mm	100 mm	100 mm	230 mm	100 mm	230 mm
Diametro taglio disco (max) Cut diameter disk (max)	490 mm	815 mm	1090 mm	1800 mm	2700 mm	2500 mm
Velocità taglio Cut speed	22 m/min	17 m/min	17 m/min	13-26 m/min	17 m/min	13-26 m/min
Diametro lame Blades diameter	ø 53 mm	ø 67 mm	ø 67 mm	ø 120 mm	ø 67 mm	ø 120 mm
Chiusura archetto Bow closing	(M) (P)	(M) (P)	(M) (P)	(P)	(P)	-
Potenza assorbita Absorbed power	0,55 kW	0,75 kW	0,75 kW	0,9-1,75 kW	0,75 kW	0,9-1,75 kW
Tensione di alimentazione Voltage	400V, ~3, 50/60 Hz					
Peso / Weight	140 kg	330 kg	450 kg	1000 kg	870 kg	915 kg

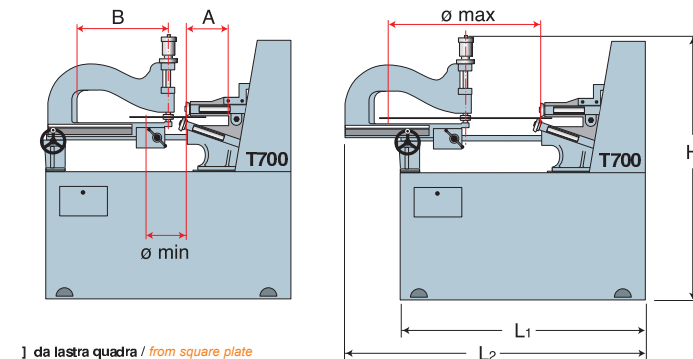

] da lastra quadrata / from square plate
n da lastra scantonata / from corner shaped plate
(P) Chiusura archetto pneumatico / pneumatic bow closing
(M) Chiusura archetto manuale / manual bow closing
o.r. = su richiesta / on request